

# OFFERING MEMORANDUM

321 BILLERICA ROAD  
CHELMSFORD, MA . 01824

## INVESTMENT OPPORTUNITY

72,050 SF MEDICAL BUILDING



Chelmsford Medical & Surgical Center



**ROB MCGARRY**  
**SENIOR ASSOCIATE**

ROB@OBRIENCOMMERCIAL.COM . 978.209.3211



O'BRIEN COMMERCIAL PROPERTIES  
336 BAKER AVENUE . CONCORD, MA - 01742 . 978.369.5500  
OBRIENCOMMERCIAL.COM

321 BILLERICA ROAD . CHELMSFORD, MA . 01824

Executive Summary

Investment Highlights **Medical & Surgical Center**

Location & Demographics

Map

Site Plan

Gallery

Floor Plans

Rent Roll

Operating Income & Expenses

We obtained the following information above from sources we believe to be reliable. However, we have not verified its accuracy and make no guarantee, warranty or representation about it. It is submitted subject to the possibility of errors, omissions, change of price, rental or other conditions, prior sale, lease or financing, or withdrawal without notice. We include projections, opinions, assumptions or estimates for example only, and they may not represent the current or future performance of the property. You and your tax and legal advisors should conduct your own investigation of the property and transaction.

# Executive Summary

## Chelmsford Medical & Surgical Center

O'Brien Commercial Properties is pleased to present the opportunity to purchase the Chelmsford Medical & Surgical Center, located at 321 Billerica Road in Chelmsford, MA. Strategically positioned just off Route 3 and I-129, this property offers unparalleled accessibility to major transportation routes, enhancing its appeal for a range of commercial uses, particularly in the medical and healthcare sectors.

The Chelmsford Medical & Surgical Center is a well-established, 90% occupied medical building, providing a stable income stream with a strong tenant base. The property's high occupancy rate reflects its status as a sought-after location for medical professionals and healthcare providers. The center's prime location offers excellent visibility and proximity to other medical offices, retail amenities, and residential communities, making it a highly attractive destination for both patients and tenants.

Chelmsford's thriving economy, a highly educated workforce, and top-tier school systems further increase the property's appeal. Its strategic position between the Boston metro area and the surrounding suburban markets provides businesses with access to a skilled labor pool and a high quality of life. The town's strong local economy, coupled with its growing commercial and residential sectors, makes 321 Billerica Road a promising investment opportunity with significant potential for long-term appreciation.

This offering represents an exceptional opportunity for investors to acquire a prime, income-generating property with a solid tenant roster in a rapidly growing market. With a combination of location, stability, and future growth potential, the Chelmsford Medical & Surgical Center is an ideal investment for those looking to capitalize on Chelmsford's dynamic economic landscape.

# Investment Highlights

Chelmsford Medical & Surgical Center

## SPECIFICATIONS

BUILDING SIZE	72,050 SF
LOT SIZE	5.00
YEAR BUILT	1984
ZONING TYPE	Light Industrial (IA)
USE	Medical Office
NUMBER OF STORIES	Two (2)
TYPICAL FLOOR	36,025
PARKING RATIO	3.58/1,000 SF
ELEVATOR	Freight, Passenger
LOADING	Two (2) dock height
CEILING HEIGHT	12' to deck
SPRINKLER	Wet System
Water/ Sewer	Town of Chelmsford
HVAC	Full heat/ AC

## Investment Highlights

Occupancy	90%
NET OPERATING INCOME	\$766,640
PRICING GUIDANCE	Market



Investment Highlights | 321 Billerica Rd

# Location

## Chelmsford Medical & Surgical Center

### ABOUT CHELMSFORD

Chelmsford is a thriving town located in Middlesex County, Massachusetts, known for its strategic location, strong economic growth, and excellent quality of life. Situated about 24 miles north of downtown Boston, Chelmsford offers convenient access to major highways such as I-495, Route 3, and I-93, making it an attractive destination for businesses seeking proximity to the Boston metro area while enjoying a suburban setting. The town's well-developed infrastructure, combined with its skilled workforce, creates an ideal environment for both commercial and residential development.

Chelmsford has a diversified economy with key sectors including technology, healthcare, retail, and professional services. The town is home to several major corporations and business parks, particularly in the technology and industrial sectors. Additionally, the town benefits from a strong local workforce with a highly educated population, contributing to its business-friendly atmosphere.

With a range of amenities including parks, excellent schools, and recreational facilities, Chelmsford appeals to both businesses and residents. The town's mix of suburban charm and access to metropolitan opportunities makes it an ideal location for both corporate tenants and employees. Chelmsford's housing market is robust, offering a variety of housing options that further enhance the area's attractiveness.



### Demographics

	2 MILES	5 MILES	10 MILES
TOTAL POPULATION	18,976	195,397	452,188
TOTAL HOUSEHOLDS	7,125	71,421	164,369
AVERAGE HH INCOME	\$135k	\$113k	\$138k
MEDIAN HOME VALUE	\$479k	\$444k	\$559k
DAYTIME EMPLOYEES	21,081	84,531	269,586
TOTAL CONSUMER SPENDING	\$283 M	\$2.49 B	\$6.58 B

Location | 321 Billerica Rd

# Map

3

Chelmsford Medical & Surgical Center

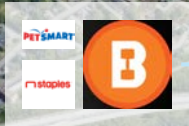

321 BILLERICA ROAD  
CHELMSFORD, MA . 01824

Map | 321 Billerica Rd

3

321 BILLERICA ROAD · CHELMSFORD, MA 01824

# The Property

Chelmsford Medical & Surgical Center



The Property | 321 Billerica Rd

321 BILLERICA ROAD · CHELMSFORD, MA · 01824



# Gallery

Chelmsford Medical & Surgical Center



Gallery | 321 Billerica Rd



321 BILLERICA ROAD · CHELMSFORD, MA · 01824



# Floor Plans

Chelmsford Medical & Surgical Center

# 1ST

- 01** West Suburban Eye Surgery Center
- 02** Psychological Care
- 03** SRS Medical
- 04** Office Link

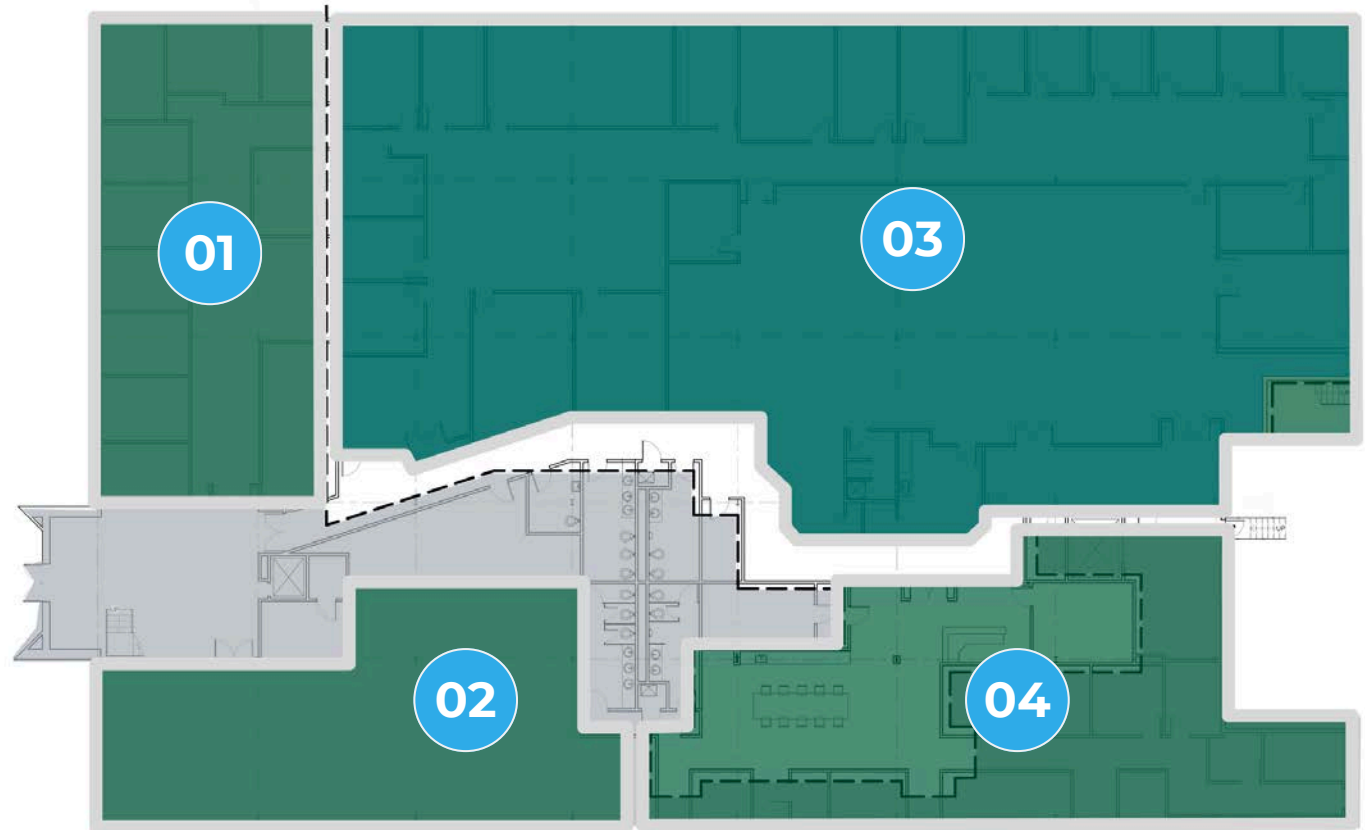

1ST Floor | 321 Billerica Rd

# Floor Plans

Chelmsford Medical & Surgical Center

# 2ND

- 01** MA ENT
- 02** Columbia Care, LLC
- 03** Clover Behavioral
- 04** Available

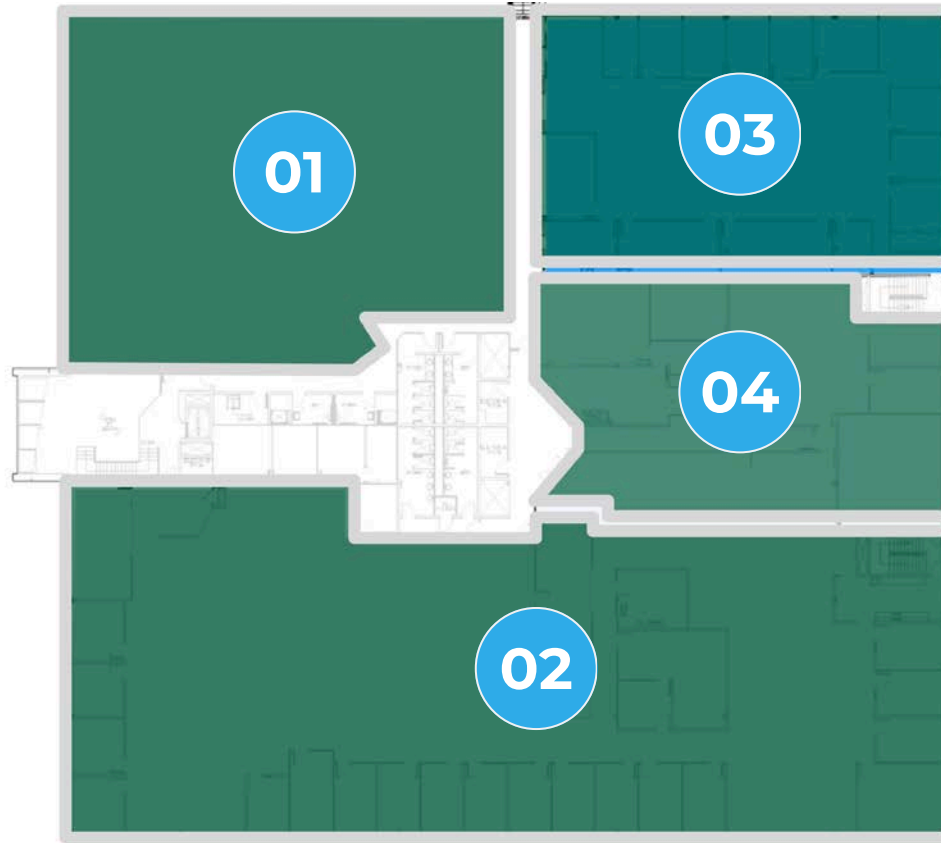

2ND Floor | 321 Billerica Rd

321 BILLERICA ROAD . CHELMSFORD, MA . 01824

---



## Chelmsford Medical & Surgical Center

### CONFIDENTIALITY & DISCLAIMER

The information contained in the following offering memorandum is proprietary and strictly confidential. It is intended to be reviewed only by the party receiving it from O'Brien Commercial Properties and it should not be made available to any other person or entity without the written consent of O'Brien Commercial Properties. By taking possession of and reviewing the information contained herein the recipient agrees to hold and treat all such information in the strictest confidence. The recipient further agrees that recipient will not photocopy or duplicate any part of the offering memorandum. If you have no interest in the subject property, please promptly return this offering memorandum to O'Brien Commercial Properties. This offering memorandum has been prepared to provide summary, unverified financial and physical information to prospective purchasers, and to establish only a preliminary level of interest in the subject property. The information contained herein is not a substitute for a thorough due diligence investigation. O'Brien Commercial Properties has not made any investigation, and makes no warranty or representation with respect to the income or expenses for the subject property, the future projected financial performance of the property, the size and square footage of the property and improvements, the presence or absence of contaminating substances, PCBs or asbestos, the compliance with local, state and federal regulations, the physical condition of the improvements thereon, or financial condition or business prospects of any tenant, or any tenant's plans or intentions to continue its occupancy of the subject property. The information contained in this offering memorandum has been obtained from sources we believe reliable; however, O'Brien Commercial Properties has not verified, and will not verify, any of the information contained herein, nor has O'Brien Commercial Properties conducted any investigation regarding these matters and makes no warranty or representation whatsoever regarding the accuracy or completeness of the information provided. All potential buyers must take appropriate measures to verify all of the information set forth herein. Prospective buyers shall be responsible for their costs and expenses of investigating the subject property.



**ROB MCGARRY**  
**SENIOR ASSOCIATE**

ROB@OBRIENCOMMERCIAL.COM . 978.209.3211



O'BRIEN COMMERCIAL PROPERTIES  
336 BAKER AVENUE . CONCORD, MA - 01742 . 978.369.5500  
OBRIENCOMMERCIAL.COM